

## Welding-in thermowell

### Solid drills

Form 4 acc. to DIN 43772

for thermometer with male thread



### Description

These thermowells TW997 are acc. to DIN 43772 form 4.

They have to be welded-in into the process and resist high stresses caused by strong vibrations, flow rates, high pressures and temperatures.

With special dimensions they are equivalent with thermowells D1-D4 acc. to DIN 43763.

### Technical data

<b>Model</b>	TW997
<b>Max. process temperature</b>	600°C
<b>Max. process pressure (statical)</b>	150 bar
<b>Thermowell material</b>	
Standard	Stainless steel 1.4571
Optional	Steel 1.0460 ; Special materials
<b>Outer diameter</b>	18mm, 24mm, 26mm, 32mm
<b>Connection to thermometer</b>	Female: M14x1,5, M18x1,5, G1/2, G3/4
<b>Bore size</b>	3,5mm, 7mm, 9mm, 11mm
<b>Insertion length U</b>	65mm, 73mm, 125mm, 133mm, 275mm
<b>Total length L</b>	110mm, 140mm, 170mm, 200mm, 260mm, 410mm

<sup>1)</sup> The rating depends on the process medium, -pressure, -temperature, flow rate and the design of the thermowell. With critical applications, a separate wake frequency calculation is recommended.

Model: TW997

## Dimensions

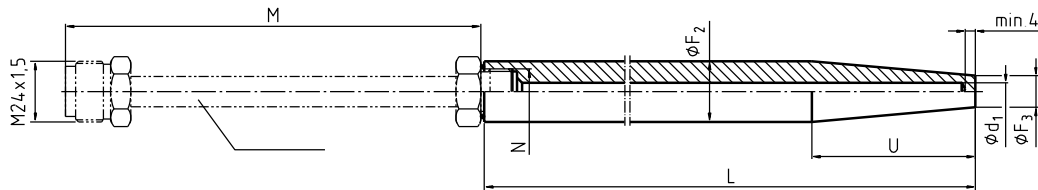
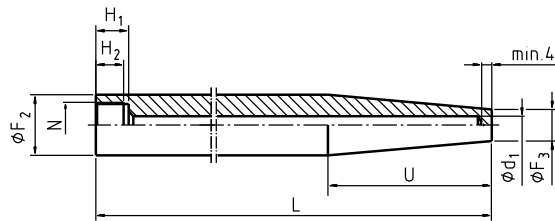

## Legend

L	Total length
M	Extension tube length
N	Connection to thermometer
U	Insertion length
Ø	Total length
Ød <sub>1</sub>	Bore size
ØF <sub>2</sub>	Outer diameter
ØF <sub>3</sub>	Outer diameter, tapered

L	U	G	weight [kg]
110	65	105	0,24
110	73	105	0,23
140	65	135	0,34
170	133	165	0,34
200	65	195	0,54
200	125	195	0,45
260	125	255	0,65
410	275	405	0,92

Ød <sub>1</sub>	ØF <sub>2</sub>	N	ØF <sub>3</sub>	H <sub>1</sub>	H <sub>2</sub>
3,5	18	M14x1,5	9	16	13
7	24	M18x1,5	12,5		
	9	G1/2		15	19
11	32		G3/4	17	22

## Suitable thermometer stem length I<sub>1</sub>

Design of connection	Thermometer length I <sub>1</sub>	I <sub>1</sub> in combination with extension tube
S Standard, male thread	I <sub>1</sub> =L-10mm	---
2 Male nut	I <sub>1</sub> =L-30mm	---
3 Union nut	---	I <sub>1</sub> =L-10mm+M

## Comparison old models acc. to DIN 43763 – dimensions acc. to DIN 43772

DIN 43763	L	U	d <sub>1</sub>	F <sub>2</sub>	N	Article-Key
D1	140	65	7	24	M18x1,5	TW997X326019
D2	200	125	7	24	M18x1,5	TW997X326014
D4	200	65	7	24	M18x1,5	TW997X326015
D5	260	125	7	24	M18x1,5	TW997X326018

Subject to technical modifications